

## A Shady Spot

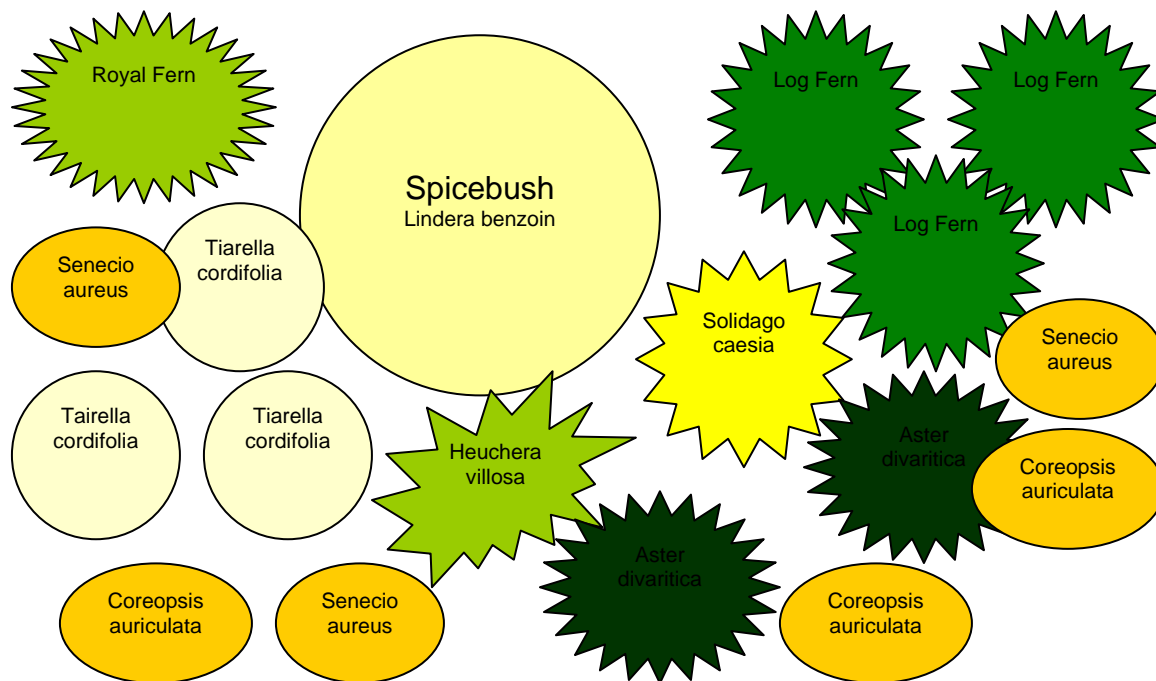

Approximate dimensions of completed garden: 14 feet wide by 10 feet deep.

This is a lovely little plan for a shady garden, full of flowering plants, foliage and multi-season interest. Many of the plants are bird and butterfly favorites, too. All of the suggested plants are native to the eastern United States.

You will need:

- One Royal Fern
- Three Log Ferns
- One Spicebush
- One Heuchera macrorrhiza
- Three Tiarella cordifolia
- Three Senecio aureus
- Three Coreopsis auriculata
- Two Aster divaritica
- One Solidago caesia

# Shy Valley Native Habitat Nursery

Connecting gardens to nature since 2001

423/348-6570

[www.shyvalley.com](http://www.shyvalley.com)